

DESIGN PARAMETERS:

- Single, 4-lane roadway for Engle Road.
- 35 MPH design speed.
- Signalized intersection at Snow Road East Ramp / Snow Road West Ramp with Engle Road.
- Maintains roadway split between Snow Road East Ramp and Snow Road West Ramp.
- Snow Road Turnaround relocated.
- Portions of Ford Drive eliminated.

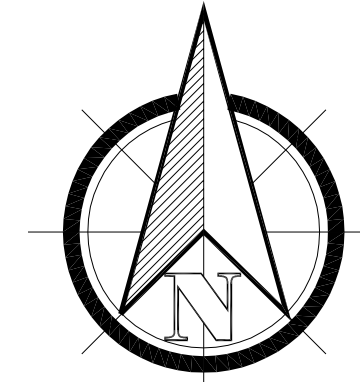

Parcel #	Property Owner
342-07-001	Ford Motor Company
342-18-002	
343-01-001	
343-02-001	
342-08-024	Treadway, Raymond H.
342-16-003	Consolidated Railway Corp.
342-17-003	
342-16-011	Cp - Cleveland Holdings
342-16-012	Marc's Warehouse
342-17-001	Manuel Chavez III
342-17-006	Goodyear / Crow Holdings
343-02-002	Hoffman Properties Limited & Partnership Two
343-02-004	
343-03-001	Drummond Dolomite
343-03-009	
343-03-002	Altis Investments LTD.
343-03-007	Local 1250 UAW AFL-CIO

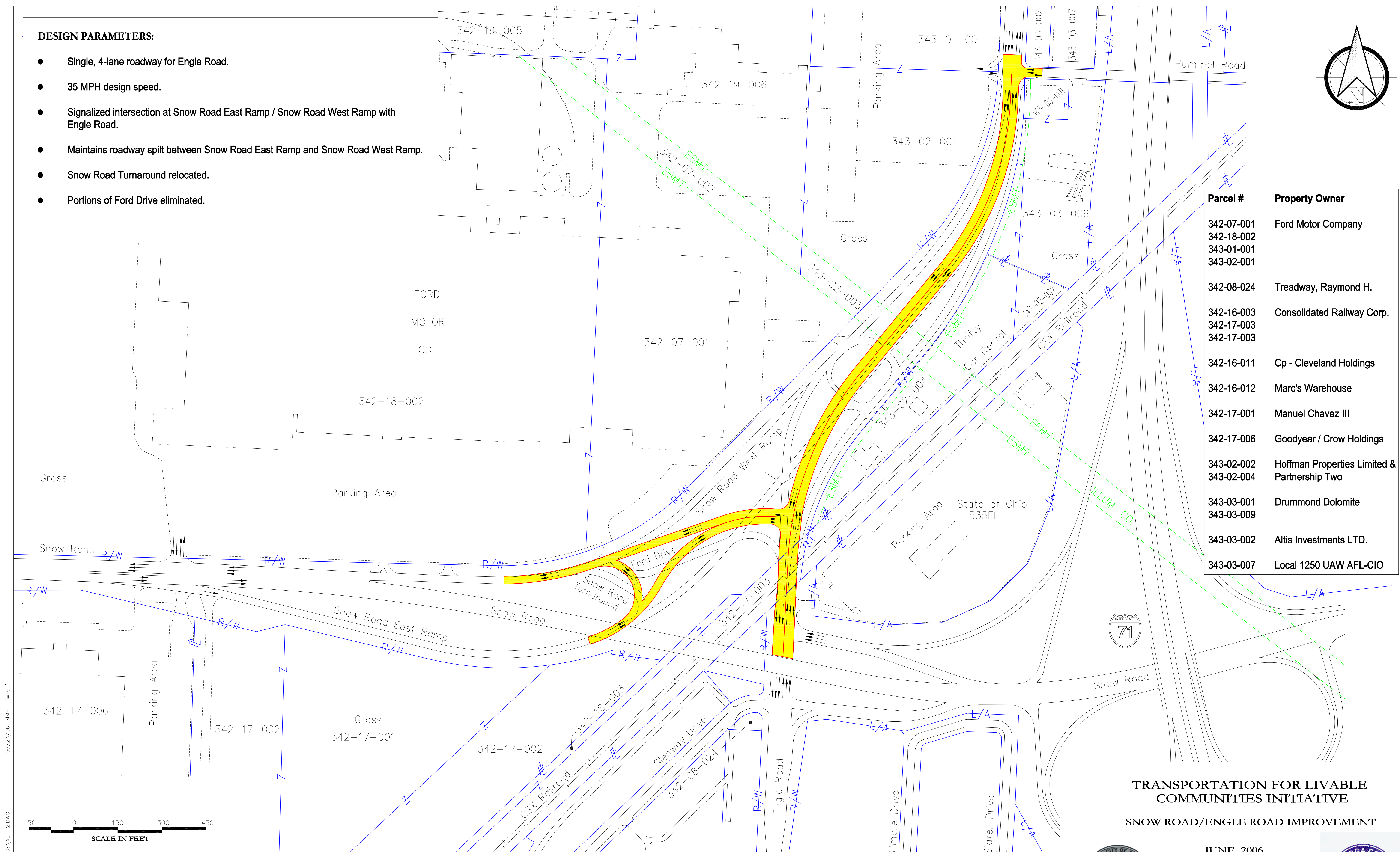

Conceptual Alternative 1

TRANSPORTATION FOR LIVABLE COMMUNITIES INITIATIVE
SNOW ROAD/ENGLE ROAD IMPROVEMENT

JUNE, 2006

CITY OF BROOK PARK
 CUYAHOGA COUNTY, OHIO



F:\JOBS\702\DRAWINGS\ALT-2.DWG 05/23/06 MMP 1"=150'